

**PUMP, VALVE AND DAM
EQUIPMENT
DISMANTLING JOINT**

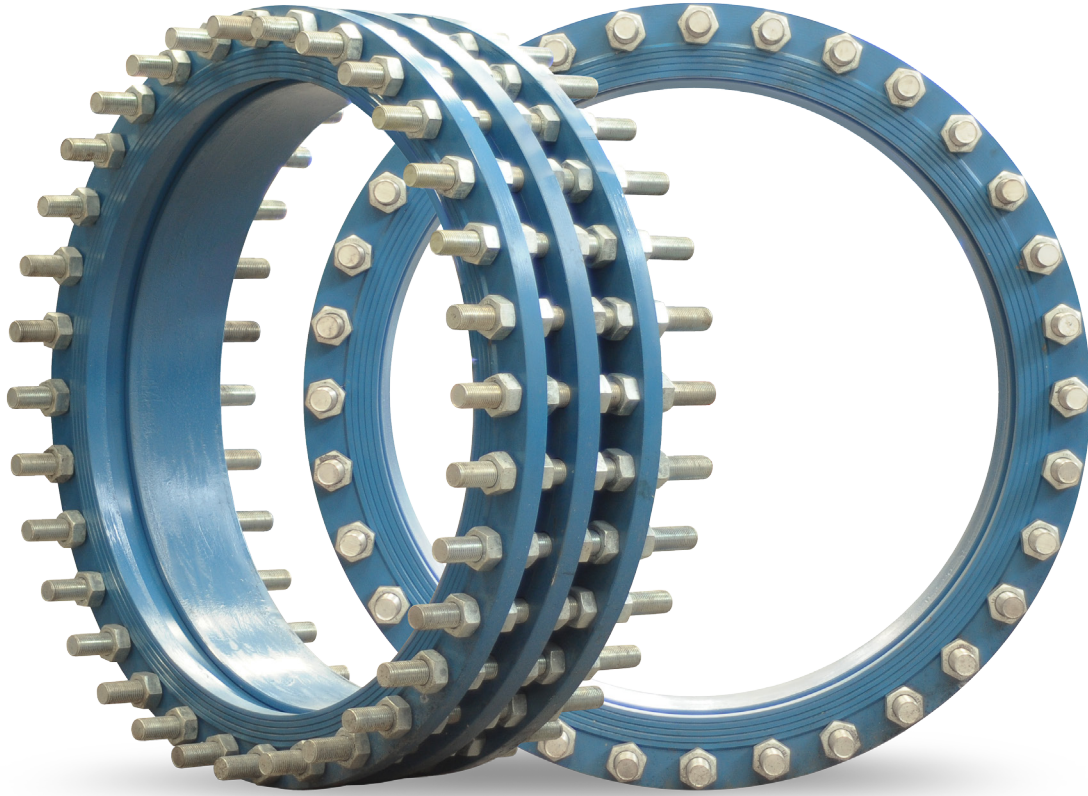

DESIGN

- TS K 461
- Flanges according to DIN EN1092
- Easily fixing to valves
- Three parts body design
- Movement Capability $\pm 25\text{mm}$
- Maximum operating temperature 50°C

MATERIAL

- Body ductile iron GGG 40/50
- EPDM sealing ring
- Galvanized bolts and nuts

OPTIONAL

- DN > 2800
- Stainless steel body parts
- Bolts and nuts are stainless steel

CORROSION PROTECTION

- Electrostatic Powder Coating for Drinking Water
- Zinch – Rich Epoxy Primer
- Coal – Tar Epoxy
- Glass Flake Epoxy
- Enamel Epoxy for Ultraviolet
- Completely Stainless Steel Design
- Ebonite Coating for Seawater

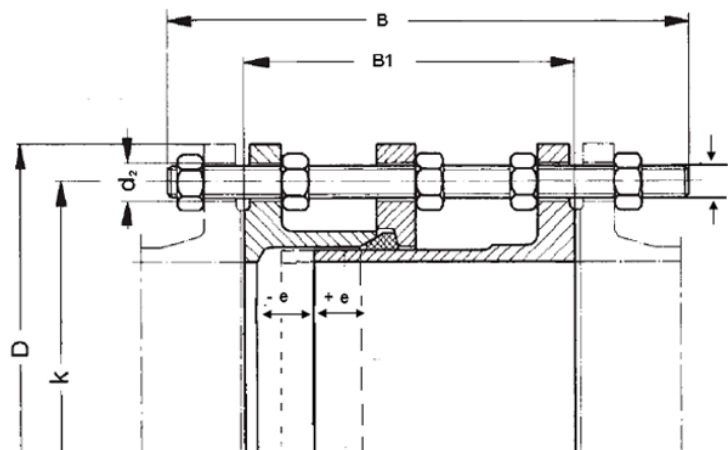

PN 10								
DN	D	k	d2	No. of Holes	B	B1	E	WEIGHT (KG)
100	220	180	19	8	310	200	25	21
150	285	240	23	8	320	200	25	35
200	340	295	23	8	340	220	25	49
250	400	350	23	12	360	220	25	64
300	455	400	23	12	360	220	25	73
350	505	460	23	16	360	230	25	96
400	565	515	28	16	370	230	25	124
450	615	565	28	20	390	250	25	141
500	670	620	28	20	390	260	25	160
600	780	725	31	20	410	260	25	207
700	895	840	31	24	410	260	25	259
800	1015	950	34	24	460	290	25	354
900	1115	1050	34	28	460	290	25	407
1000	1230	1160	37	28	480	290	25	488
1100	1340	1270	37	32	480	300	25	589
1200	1455	1380	40	32	520	320	25	748
1300	1575	1490	40	32	530	340	25	914
1400	1675	1590	43	36	560	360	25	1037
1500	1785	1700	43	36	590	380	25	1162
1600	1915	1820	49	40	600	390	25	1225
1800	2115	2020	49	44	640	400	25	1440
2000	2325	2230	49	48	650	400	25	1710
2200	2550	2440	56	52	660	400	25	2030

PN 16								
DN	D	k	d2	No. of Holes	B	B1	E	WEIGHT (KG)
100	220	180	19	8	310	200	25	21
150	285	240	23	8	320	200	25	35
200	340	295	23	12	340	220	25	52
250	400	355	28	12	370	230	25	76
300	455	410	28	12	410	250	25	93
350	520	470	28	16	410	260	25	129
400	580	525	31	16	430	270	25	164
450	640	585	31	20	430	270	25	190
500	715	650	34	20	440	280	25	243
600	840	770	37	20	480	300	25	332
700	910	840	37	24	480	300	25	368
800	1025	950	40	24	520	320	25	480
900	1125	1050	40	28	520	320	25	548
1000	1255	1170	43	28	560	340	25	719
1100	1355	1270	43	32	560	340	25	813
1200	1485	1390	49	32	600	360	25	1110
1300	1590	1490	49	32	610	370	25	1226
1400	1685	1590	49	36	630	380	25	1350
1500	1820	1710	56	36	660	400	25	1642
1600	1930	1820	56	40	660	400	25	1705
1800	2130	2020	56	44	660	400	25	2200
2000	2345	2230	62	48	700	400	25	2380
2200	2555	2440	62	52	710	400	25	3325

PN 25								
DN	D	k	d2	No. of Holes	B	B1	E	WEIGHT (KG)
100	235	190	23	8	340	220	25	32
150	300	250	28	8	370	230	25	52
200	360	310	28	12	370	230	25	76
250	425	370	31	12	410	250	25	103
300	485	430	31	16	410	250	25	134
350	555	490	34	16	440	270	25	196
400	620	550	37	16	480	280	25	248
450	670	600	37	20	480	280	25	281
500	730	660	37	20	480	300	25	327
600	845	770	40	20	520	320	25	436
700	960	875	43	24	530	340	25	573
800	1085	990	49	24	600	360	25	800
900	1185	1090	49	28	600	380	25	888
1000	1320	1210	56	28	650	400	25	1272

* All of dimensions and explanations has been given for information. SEMSAN reserve right to keep change all them off.



PUMP, VALVE & DAM
EQUIPMENTS
PRODUCT CATALOGUE

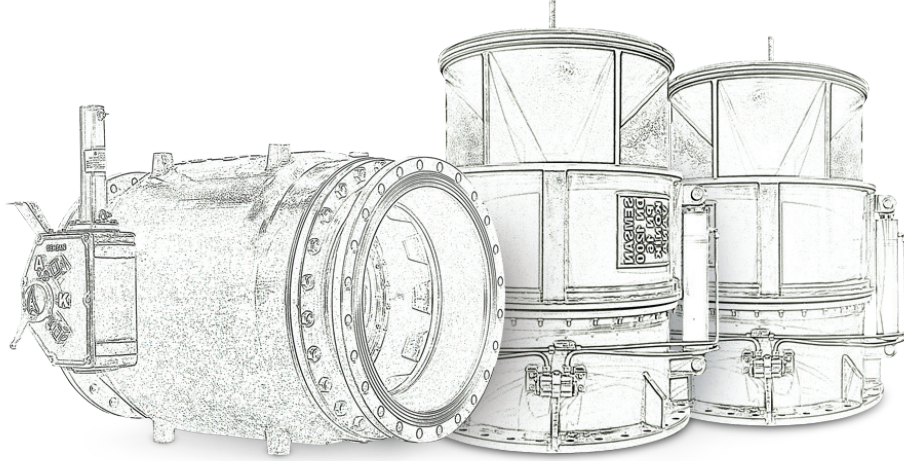

SEMSAN POMPA MAKİNA SANAYİ VE TİCARET LTD. ŞTİ.

Adres : Organize Sanayi Bölgesi Erdoğan Cebeci Bulvarı.
No:42/B Kutlukent / SAMSUN / TURKEY
Phone : +90 362 266 88 33
Fax : +90 362 266 88 58
E-mail : semsan@semsan.com.tr
Web : www.semsan.com.tr

